



19 Linksvie Road Springwood NSW

5 🛏 2 🚿 2 🚗

LOCATION - Sitting proudly on a generous corner block of approx. 1442m² in Springwood, just a stroll to the Golf Course, 550m to bus, within 750m to local school and within 3.3km to train, village & popular Springwood cafes.

STYLE - Expansive two storey brick home with tile roof and detached double garage (approx. 9m x 7m plus 3m high clearance) with remote roller door and easy access for multiple large vehicles.

LAYOUT - 2 living spaces, 5 bedrooms (3 upstairs, 2 downstairs), bathrooms on each level.

FEATURES - Upstairs kitchen with stone top benches and electric cooking, 3 x AC units, wood burner fire heater, ceiling fans, good storage, established landscaped front, side and rear yards water tank, front yard massive outdoor entertaining area (roof of garage) and rear yard salt water

Type : House
Price : \$1,080,000 - \$1,120,000
Land Size : 1442 sqm
View : <https://www.chapmanrealestate.com.au/sale/nsw/hawkesbury/springwood/residential/ho use/8137651>

[For full version visit the website](https://www.chapmanrealestate.com.au)

<https://www.chapmanrealestate.com.au>

19 LINKSVIEW ROAD, SPRINGWOOD



Ground Floor



1st Floor



INTERNAL
169 m²

EXTERNAL
11 m²

TOTAL
180 m²



The floor plan is not to scale; measurements are indicative and in metres. All features included in this 3D plan are for inspiration purposes only. This is not an exact replica of the property or the position of exterior elements. Plans should not be relied on. Interested parties should make and rely on their own enquiries.

19 LINKSVIEW ROAD, SPRINGWOOD



Ground Floor



1st Floor

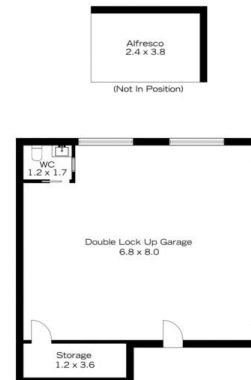

INTERNAL
169 m²

EXTERNAL
11 m²

TOTAL
180 m²



The floor plan is not to scale; measurements are indicative and in metres. Exterior elements are not in position. Plans should not be relied on. Interested parties should make and rely on their own enquiries.