



1/2 Dora Street Katoomba NSW

1 1 2

LOCATION - Easy access to World Heritage listed national park, Katoomba village & the vibrant restaurant & café scene, arts & culture, rail, bus, Katoomba Hospital & the Great Western Highway.

STYLE - Brand new luxury townhouses redefining expectations of living and setting a new standard for homes in Katoomba and the Blue Mountains region.

LAYOUT - Generous open plan living, double sized bedroom with built-in robe, generous patios, single garage and additional off street parking.

FEATURES - Designed by award winning team Integrated Design Group to allow spectacular facades, vaulted

Type	: Townhouse
Price	: \$ 650,000
Building Size	: 73 sqm
Land Size	: 144 sqm
View	: https://www.chapmanrealestate.com.au/sale/nsw/blue-mountains-surrounds/katoomba/residential/townhouse/8137242

[For full version visit the website](https://www.chapmanrealestate.com.au)



Jonathan Crisp
02 4754 8266



Hayley Clifton
02 4782 5945

<https://www.chapmanrealestate.com.au>

UNIT 1

1 Bed / 1 Bath / 2 Car

73m² internal floor space

144m² overall

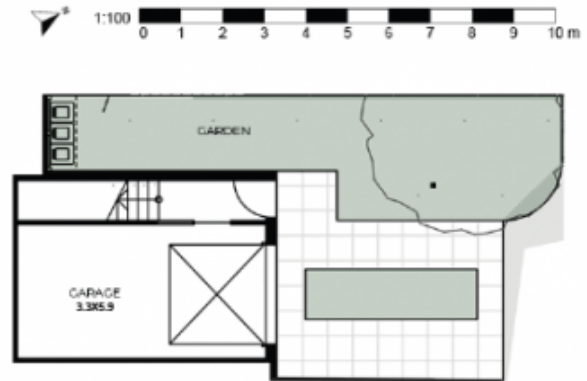

Disclaimer: Unit areas are just estimates and are to be used as a guide only. Dimensions, areas, fittings and fixtures are subject to change and adjustment during the course of construction