



27A Wilson Way Blaxland NSW

2 1 2

LOCATION: Moments to rail with pedestrian friendly and accessible access to rail and Blaxland shops.

Zoning: R2, block size approximately 710sqm.

STYLE: Single level, clad garden cottage built circa 1960.

LAYOUT: Open plan dining and living with large windows, 2 bedrooms of ample size, additional sun-room & study.

FEATURES: Reverse cycle air-con, ceiling fan, original kitchen and bathroom, high ceilings, built in robes, utility room outside, 2nd toilet, gently sloping yard and single lock up garage.

Disclaimer: All information contained herein is gathered from sources we believe to be reliable. However, we cannot guarantee its accuracy & interested persons should rely on their own inquiries.

[For full version visit the website](https://www.chapmanrealestate.com.au)

Type : House
Price : \$890,000 - \$950,000
Land Size : 695 sqm
View : <https://www.chapmanrealestate.com.au/sale/nsw/blue-mountains-surrounds/blaxland/residential/house/8119194>



Tennille Haddock
02 4739 4311

27A WILSON WAY, BLAXLAND

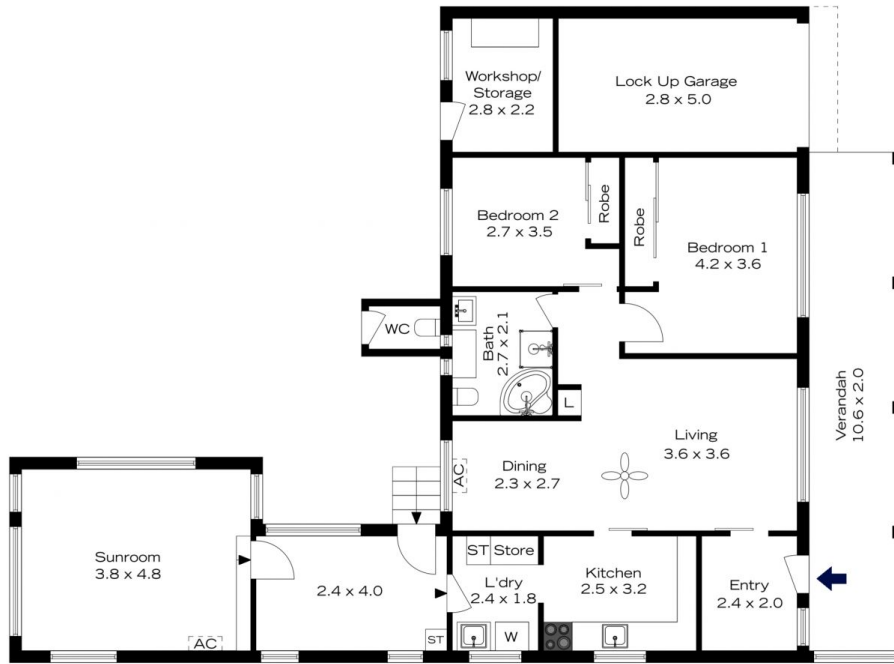

INTERNAL
125 m²

EXTERNAL
22 m²

TOTAL
147 m²



The floor plan is not to scale; measurements are indicative and in metres. Exterior elements are not in position. Plans should not be relied on. Interested parties should make and rely on their own enquiries.

27A WILSON WAY, BLAXLAND



INTERNAL
125 m²

EXTERNAL
22 m²

TOTAL
147 m²



The floor plan is not to scale; measurements are indicative and in metres. All features included in this 3D plan are for inspiration purposes only. This is not an exact replica of the property or the position of exterior elements. Plans should not be relied on. Interested parties should make and rely on their own enquiries.