



### 48 Ridge View Close Winmalee NSW

4 2 2

**SITUATION** - Prestige location that offers privacy and peaceful surrounds, this commanding residence positioned on 869.9sqm approx. land within easy access to Winmalee shopping village, childcare facilities, primary and high schools, great access to Blue Gum Swamp Track.

**STYLE** - Elevated brick and Colorbond modern style home.

**LAYOUT** - 3 generous and separate living rooms, 4 bedrooms all double with built-ins, primary with walk-in robe and ensuite, open plan kitchen with meals area.

**FEATURES** - High ceilings, superb valley views, warm contemporary feel throughout, ducted reverse cycle air-conditioning, gourmet kitchen with stone benches,

**Type** : House  
**Price** : \$ 1,312,000  
**Land Size** : 869.9 sqm  
**View** : <https://www.chapmanrealestate.com.au/sale/nsw/hawkesbury/winmalee/residential/house/8119102>

[For full version visit the website](https://www.chapmanrealestate.com.au)

<https://www.chapmanrealestate.com.au>

# 48 RIDGE VIEW CLOSE, WINMALEE



Ground Floor



Lower Ground Floor

**INTERNAL**  
270 m<sup>2</sup>

**EXTERNAL**  
60 m<sup>2</sup>

**TOTAL**  
330 m<sup>2</sup>



The floor plan is not to scale; measurements are indicative and in metres. All features included in this 3D plan are for inspiration purposes only. This is not an exact replica of the property or the position of exterior elements. Plans should not be relied on. Interested parties should make and rely on their own enquiries.

# 48 RIDGE VIEW CLOSE, WINMALEE

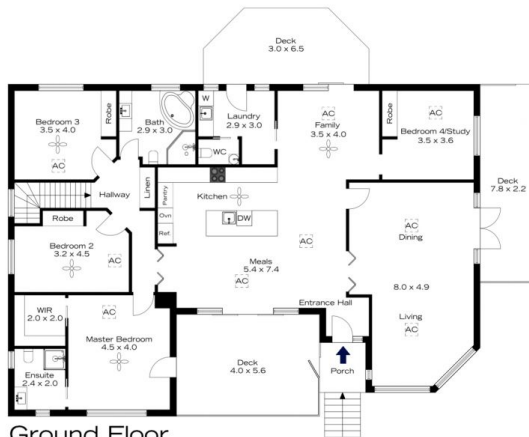

Ground Floor



Lower Ground Floor

**INTERNAL**  
270 m<sup>2</sup>

**EXTERNAL**  
60 m<sup>2</sup>

**TOTAL**  
330 m<sup>2</sup>



The floor plan is not to scale; measurements are indicative and in metres. Exterior elements are not in position. Plans should not be relied on. Interested parties should make and rely on their own enquiries.