



20 Lugano Avenue Springwood NSW

5 🛏 3 🚿 2 🚗

LOCATION: Situated in a sought-after tranquil location, in a quiet cul de sac, this home boasts convenience, being in close proximity to the Aquatic Centre, Buttenshaw Park and a pleasant 1.2km stroll to Springwood village.

STYLE: Highset, brick and tile home, set on a 1028m2 fully enclosed, private and established yard, providing a sense of security and seclusion.

LAYOUT: This home offers two spacious living areas, separate study, 5 bedrooms (4th bedroom single size), all with built-in wardrobes. The primary bedroom features en-suite and a walk-in wardrobe. The 5th bedroom includes a sitting area and 2nd en-suite, ideal for teenagers or extended family. Open plan kitchen and family room flow through to the covered alfresco entertaining area and a captivating landscaped oasis featuring a level, lush garden

Type : House
Price : \$ 1,305,000
Land Size : 1028 sqm
View : <https://www.chapmanrealestate.com.au/sale/nsw/hawkesbury/springwood/residential/ho use/7914074>

[For full version visit the website](https://www.chapmanrealestate.com.au)

<https://www.chapmanrealestate.com.au>

20 LUGANO AVENUE, SPRINGWOOD



INTERNAL
270 m²

EXTERNAL
45 m²

TOTAL
315 m²



The floor plan is not to scale; measurements are indicative and in metres. All features included in this 3D plan are for inspiration purposes only. This is not an exact replica of the property or the position of exterior elements. Plans should not be relied on. Interested parties should make and rely on their own enquiries.

20 LUGANO AVENUE, SPRINGWOOD

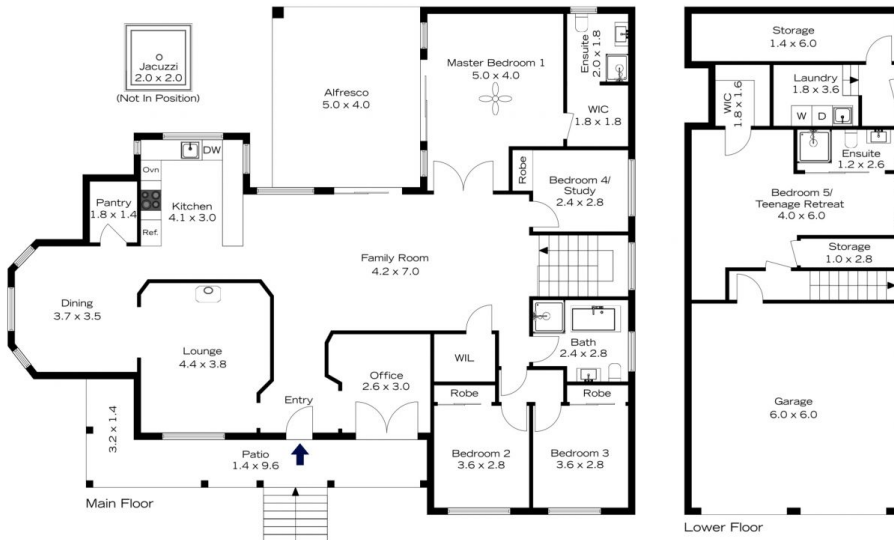

INTERNAL
246 m²

EXTERNAL
43 m²

TOTAL
289 m²



The floor plan is not to scale; measurements are indicative and in metres. Exterior elements are not in position. Plans should not be relied on. Interested parties should make and rely on their own enquiries.