



### 6 Nichols Parade Mount Riverview NSW

3 1 1

**LOCATION:** Sitting quietly on an 581 m2 approx. parcel of land, this home is conveniently located within easy access to the local primary school, convenience store, parks and café. The bus stop is within 650m of the home and the train station less than 2.7km commuting is effortless. Positioned in a leafy and peaceful family friendly suburb, bush walks and everything the lower Blue Mountains has to offer is at your doorstep.

**Type** : House  
**Price** : \$ 955,000  
**Land Size** : 581 sqm  
**View** : <https://www.chapmanrealestate.com.au/sale/nsw/hawkesbury/mount-riverview/residential/house/7906370>

**STYLE:** Loads of character with some original features and plenty of sunlight streaming in, this single level brick veneer & tile home is instantly inviting with a lovely feel.

**LAYOUT:** The main living area is open and spacious with an original large timber fireplace and private deck

[For full version visit the website](#)

<https://www.chapmanrealestate.com.au>

6 NICHOLS PARADE, MOUNT RIVERVIEW



**INTERNAL**  
114 m<sup>2</sup>

**EXTERNAL**  
60 m<sup>2</sup>

**TOTAL**  
174 m<sup>2</sup>



The floor plan is not to scale; measurements are indicative and in metres. All features included in this 3D plan are for inspiration purposes only. This is not an exact replica of the property or the position of exterior elements. Plans should not be relied on. Interested parties should make and rely on their own enquiries.

6 NICHOLS PARADE, MOUNT RIVERVIEW

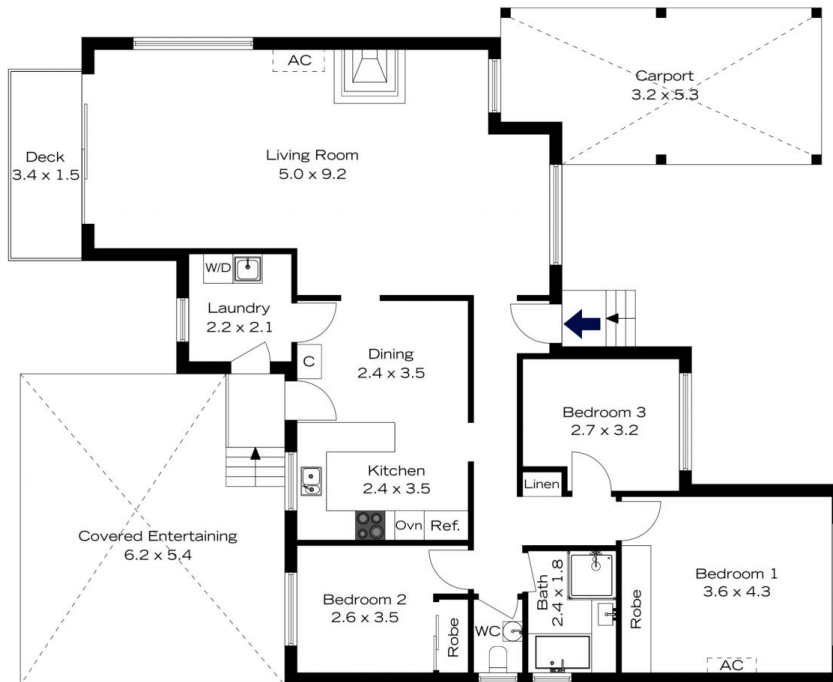

**INTERNAL**  
114 m<sup>2</sup>

**EXTERNAL**  
60 m<sup>2</sup>

**TOTAL**  
174 m<sup>2</sup>



The floor plan is not to scale; measurements are indicative and in metres. Exterior elements are not in position. Plans should not be relied on. Interested parties should make and rely on their own enquiries.