

201 Rusden Road Mount Riverview NSW

4 2 2

Location - Leafy, peaceful and convenient to local amenities of Mount Riverview shops, preschool, primary school, parks and bushwalks all within approx. 500m. Take a moment to enjoy the peaceful surrounds. Some neighbours have been here for more than 50 years which shows a real tribute to the beauty of this area.

Style - Modern and contemporary family home, which is deceptively spacious in size inside, with a sprawling yard, rare to find in the lower Mountains.

Layout - Showcasing a split-level design, this home offers an ease of connection from the family living areas to the bedrooms. With an upstairs parent's retreat, ensuite and walk in robe you will have the opportunity for privacy or to

Type : House
Price : \$ 1,390,000
Land Size : 1595 sqm
View : <https://www.chapmanrealestate.com.au/sale/nsw/hawkesbury/mount-riverview/residential/house/7906364>

[For full version visit the website](https://www.chapmanrealestate.com.au)

<https://www.chapmanrealestate.com.au>

201 RUSDEN ROAD, MOUNT RIVERVIEW



First Floor



Ground Floor

INTERNAL
187 m²

EXTERNAL
85 m²

TOTAL
272 m²



The floor plan is not to scale; measurements are indicative and in metres. All features included in this 3D plan are for inspiration purposes only. This is not an exact replica of the property or the position of exterior elements. Plans should not be relied on. Interested parties should make and rely on their own enquiries.

201 RUSDEN ROAD, MOUNT RIVERVIEW

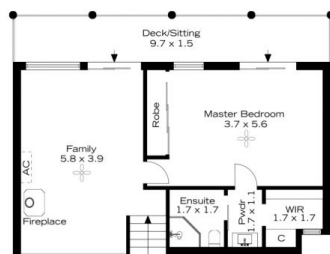

First Floor

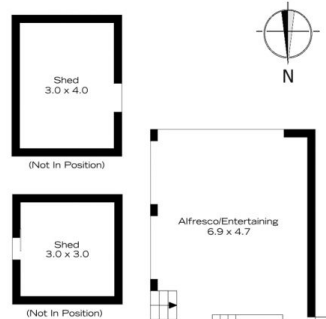

Ground Floor

INTERNAL
187 m²

EXTERNAL
85 m²

TOTAL
272 m²



The floor plan is not to scale; measurements are indicative and in metres. Exterior elements are not in position. Plans should not be relied on. Interested parties should make and rely on their own enquiries.