



115 Glenbrook Road Blaxland NSW

4 2 2

LOCATION - This wonderful family residence is walking distance from the lovely Glenbrook Lagoon and a stone's throw from Mitchell's Pass making access to Penrith a breeze. There is a playground and tennis courts around the corner at Lennox Park, Blaxland Station is approx 3.3km away, and local schools and day-care are close at hand. A bus stop right out the front makes the school runs easy. Blaxland Village is only a few minutes by car, offering an array of shops, cafes and parks.

STYLE - This two storey brick & tile home has an abundance of space, with a mix of tastefully updated & original interiors. A combination of new floating timber and carpet flooring throughout adds to the overall charm of the property.

[For full version visit the website](https://www.chapmanrealestate.com.au)

Type : House
Price : \$ 1,100,000
Land Size : 556 sqm
View : <https://www.chapmanrealestate.com.au/sale/nsw/blue-mountains-surrounds/blaxland/residential/house/7891513>



Kate Spence
02 4739 6200



Hannah Cubby
02 4751 8266

115 GLENBROOK ROAD, BLAXLAND



Ground Floor

INTERNAL
146 m²
EXTERNAL
15 m²
TOTAL
161 m²

First Floor



The floor plan is not to scale; measurements are indicative and in metres. All features included in this 3D plan are for inspiration purposes only. This is not an exact replica of the property or the position of exterior elements. Plans should not be relied on. Interested parties should make and rely on their own enquiries.

115 GLENBROOK ROAD, BLAXLAND

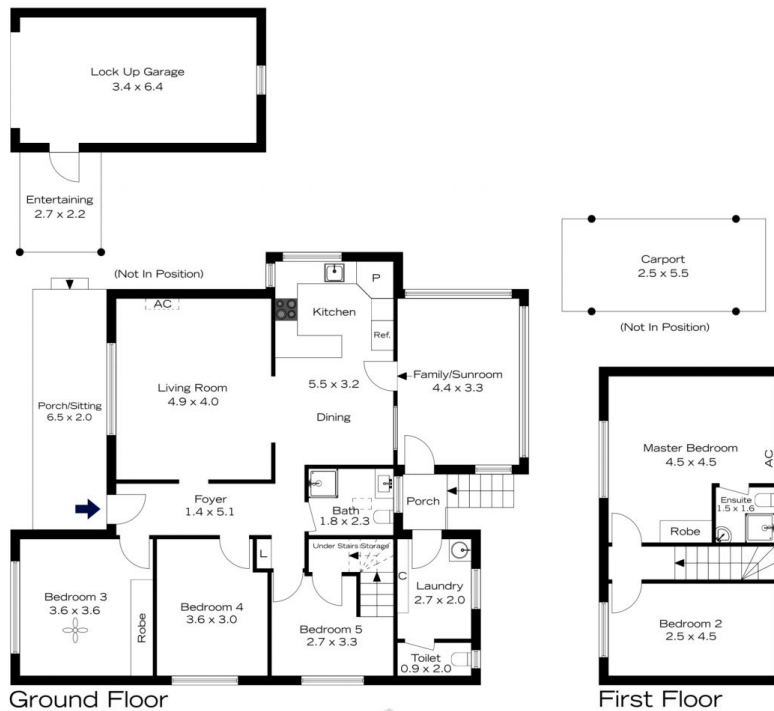

Ground Floor

INTERNAL
146 m²
EXTERNAL
15 m²
TOTAL
161 m²

First Floor



The floor plan is not to scale; measurements are indicative and in metres. Exterior elements are not in position. Plans should not be relied on. Interested parties should make and rely on their own enquiries.