



195A Rusden Road Mount Riverview NSW

5 2 2

LOCATION - Ideal location, within short stroll to local and much loved public school. Close to bush walks, local shops, bus and restaurant.

STYLE - Two storey contemporary expansive family home enjoying twinkling city lights at night and resort vibe. Light tones and a generous internal volume combine within the open plan living space, crafting a bright and pleasant atmosphere.

LAYOUT - 3 Living rooms, dining room, 5 bedrooms, primary with walk-in robe and ensuite, 2.5 bathrooms.

FEATURES - Master chef style open plan renovated kitchen with 900ml gas cooking by Miele, Ducted reverse cycle air conditioning, high ceilings, oversized rooms, wood log fire, turpentine floorboards, gas bayonet, down lights, large laundry, rear upper deck bifold doors open out onto

Type : House
Price : \$ 1,350,000
Land Size : 911 sqm
View : <https://www.chapmanrealestate.com.au/sale/nsw/hawkesbury/mount-riverview/residential/house/7714413>

[For full version visit the website](https://www.chapmanrealestate.com.au)



Milton Player
02 4739 4311



Sharon Lampert
02 4739 4311

195A RUSDEN ROAD, MOUNT RIVERVIEW

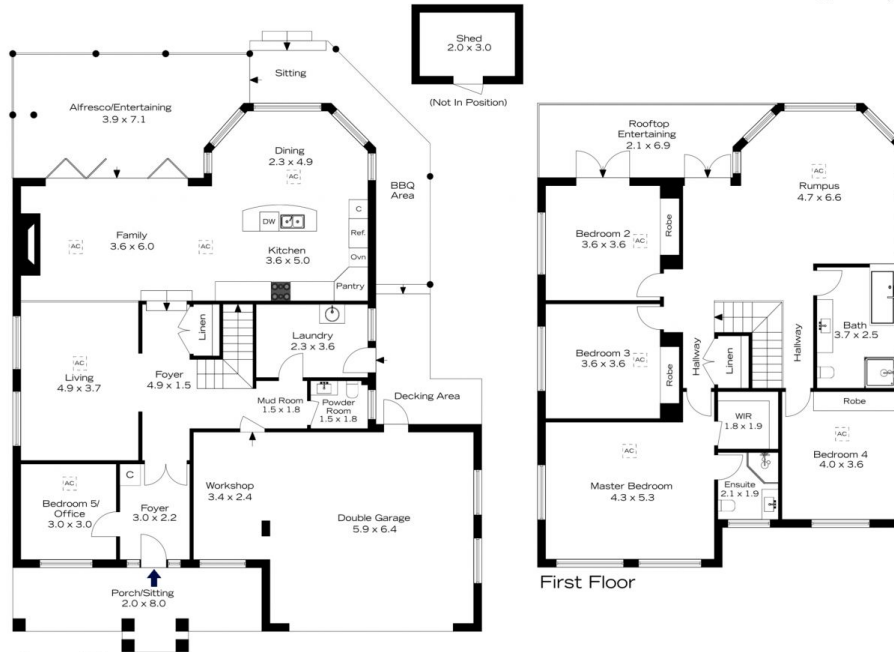

Ground Floor
INTERNAL
296 m²

EXTERNAL
83 m²

TOTAL
379 m²



The floor plan is not to scale; measurements are indicative and in metres. Exterior elements are not in position. Plans should not be relied on. Interested parties should make and rely on their own enquiries.

195A RUSDEN ROAD, MOUNT RIVERVIEW



Ground Floor

INTERNAL
296 m²

EXTERNAL
83 m²

TOTAL
379 m²



The floor plan is not to scale; measurements are indicative and in metres. All features included in this 3D plan are for inspiration purposes only. This is not an exact replica of the property or the position of exterior elements. Plans should not be relied on. Interested parties should make and rely on their own enquiries.