

Elevated mountains view

## 47 Brook Road Glenbrook NSW

4 2 2

**LOCATION:** Perfectly positioned down one of Glenbrook's most sought after village side streets famous for its mountain views and sunsets. Within a walk to national park lookouts and bush walks, pre and primary schools, ovals, park, tennis courts, rail and bus services, village centre, shops, restaurants, cafes and cinema.

**STYLE:** Architecturally designed modern executive residence, thoughtfully planned to take full advantage of the dreamlike bush views over the National Park and its expansive and wide 1448 sqm (approx) block. Destined to impress, this resort style home combines open plan family living with a seamless interplay of indoor and outdoor living options.

**LAYOUT:** Entry level encompasses the gorgeous, sun-lit, open plan kitchen, living and dining flowing onto the rear

[For full version visit the website](https://www.chapmanrealestate.com.au)

**Type** : House  
**Price** : \$ 1,930,000  
**Building Size** : 345 sqm  
**Land Size** : 1448 sqm  
**View** : <https://www.chapmanrealestate.com.au/sale/nsw/blue-mountains-surrounds/glenbrook/residential/house/7583935>



**Glen Power**  
02 4720 4244



47 BROOK ROAD, GLENBROOK



Ground Floor

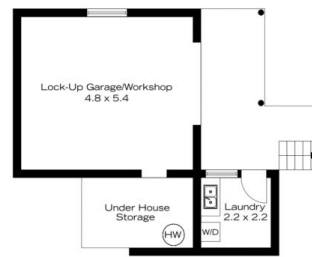

Lower Ground Floor

**INTERNAL**  
126 m<sup>2</sup>

**EXTERNAL**  
49 m<sup>2</sup>

**TOTAL**  
175 m<sup>2</sup>



The floor plan is not to scale; measurements are indicative and in metres. Exterior elements are not in position. Plans should not be relied on. Interested parties should make and rely on their own enquiries.