



## 12 Tall Timbers Road Winmalee NSW

4 2 1

**LOCATION** - Set on an accessible block in a quiet residential location, less than 1km to local shops, 2.2km to Winmalee Shopping Village, with a choice of local schools, parks and bushwalks nearby.

**STYLE** - Single level brick home with tile roof, great natural light throughout with a flexible and family friendly floor plan.

**LAYOUT** - Two separate living spaces including main lounge and rumpus room (could be used as 5th bedroom), great size study space, four bedrooms all with air conditioning including spacious master with ensuite and built in wardrobe, renovated family bathroom and external laundry.

**FEATURES** - Light and bright kitchen with dual ovens and dishwasher, open to dining space, new flooring and fresh paint throughout, reverse cycle and ducted air conditioning,

**Type** : House  
**Price** : \$ 890,000  
**Land Size** : 765.1 sqm  
**View** : <https://www.chapmanrealestate.com.au/sale/nsw/hawkesbury/winmalee/residential/house/7454650>



**Claudia Hayes**  
02 4751 8266

[For full version visit the website](https://www.chapmanrealestate.com.au)

<https://www.chapmanrealestate.com.au>

12 TALL TIMBERS ROAD, WINMALEE



INTERNAL  
168 m<sup>2</sup>

EXTERNAL  
37 m<sup>2</sup>

TOTAL  
205 m<sup>2</sup>



The floor plan is not to scale; measurements are indicative and in metres. All features included in this 3D plan are for inspiration purposes only. This is not an exact replica of the property or the position of exterior elements. Plans should not be relied on. Interested parties should make and rely on their own enquiries.

12 TALL TIMBERS ROAD, WINMALEE

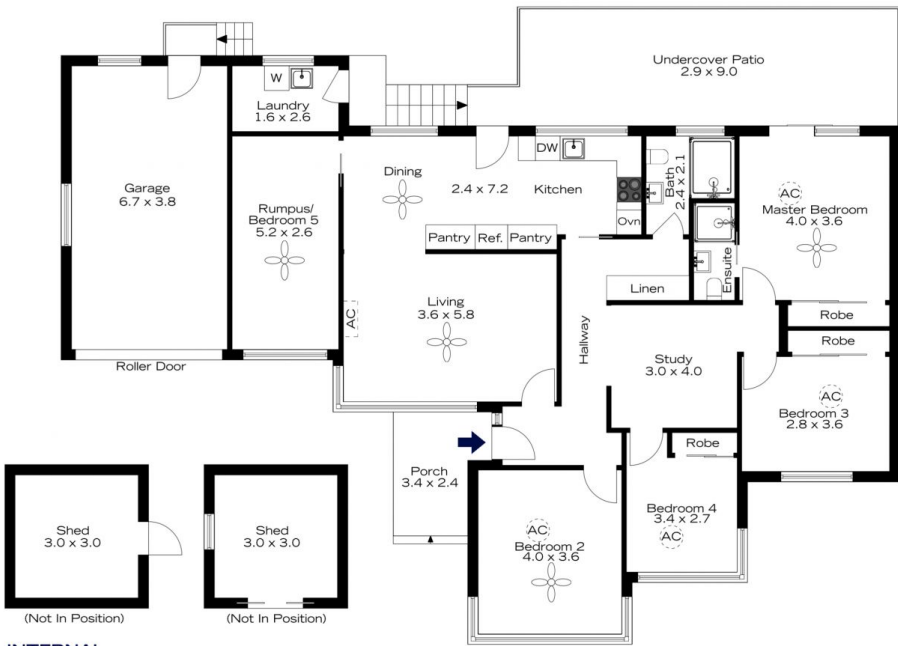

INTERNAL  
168 m<sup>2</sup>

EXTERNAL  
37 m<sup>2</sup>

TOTAL  
205 m<sup>2</sup>



The floor plan is not to scale; measurements are indicative and in metres. Exterior elements are not in position. Plans should not be relied on. Interested parties should make and rely on their own enquiries.