



203 Hawkesbury Road Winmalee NSW

4 2 2

LOCATION - Privately set back from the road behind stunning rendered brick walls, this property is 'the one you always notice.' Conveniently located within approx. 2km to Winmalee Shopping Village, schools, Summerhayes Park, medical centre and within 100m to bus stops.

STYLE - Contemporary two storey lifestyle property of rendered brick construction with tile roof and sandstone features, separate rendered brick double lock up garage plus workshop with colorbond roof - all on a massive approx. 9,371sqm (2.31 acre) block with pool, spa and a majestic bush outlook.

LAYOUT - 4 living areas including central family and living/dining, separate lounge and large

[For full version visit the website](https://www.chapmanrealestate.com.au)

Type : House
Price : \$ 1,360,000
Land Size : 9371 sqm
View : <https://www.chapmanrealestate.com.au/sale/nsw/hawkesbury/winmalee/residential/house/7409777>



Glen Power
02 4739 4311



Hannah Cubby
02 4751 8266

203 HAWKESBURY ROAD, WINMALEE

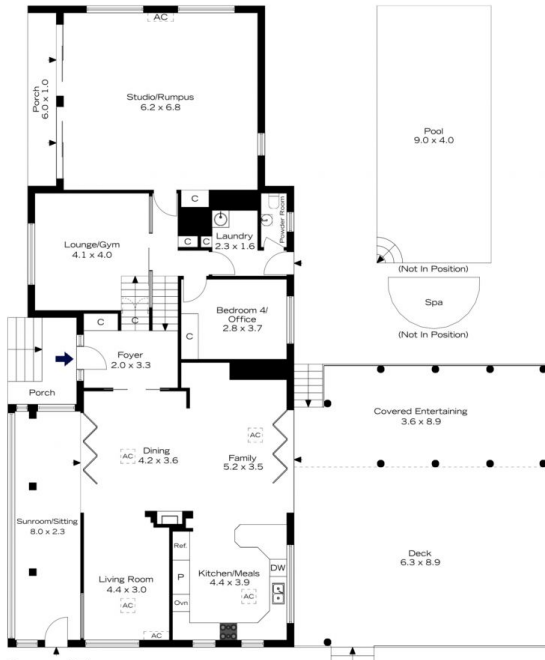

Ground Floor
INTERNAL
264 m²

EXTERNAL
115 m²

TOTAL
379 m²



The floor plan is not to scale; measurements are indicative and in metres. Exterior elements are not in position. Plans should not be relied on. Interested parties should make and rely on their own enquiries.



First Floor

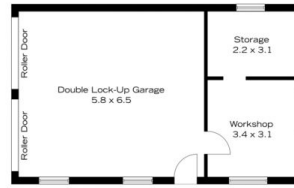

Ground Floor

203 HAWKESBURY ROAD, WINMALEE



Ground Floor

INTERNAL
264 m²

EXTERNAL
115 m²

TOTAL
379 m²



The floor plan is not to scale; measurements are indicative and in metres. All features included in this 3D plan are for inspiration purposes only. This is not an exact replica of the property or the position of exterior elements. Plans should not be relied on. Interested parties should make and rely on their own enquiries.



First Floor



Ground Floor