



9 Gumnut Close Blaxland NSW

3 1 1

LOCATION - This newly renovated home is positioned on a fantastic sized 1002sqm in a whisper-quiet cul-de-sac. Surrounded by a small number of established residences, this is a lovely little pocket of the lower Blue Mountains to reside in. Access to public transport is quick and easy with Blaxland railway station and Warrimoo station only minutes from your doorstep. Shops, cafes, schools, and daycare are all easily accessible from this convenient location.

STYLE - This delightful three-bedroom home has been completely refreshed with a brand new kitchen, updated bathroom, modern flooring including vinyl wood-look floors in the main living areas and carpet in the bedrooms, and has been freshly painted throughout. Fixtures including lighting and window coverings have all been replaced as

Type : House
Price : \$ 910,000
Land Size : 1031 sqm
View : <https://www.chapmanrealestate.com.au/sale/nsw/blue-mountains-surrounds/blaxland/residential/house/7327618>



Kate Spence
02 4739 6200



Helen Harris
02 4751 8266

[For full version visit the website](https://www.chapmanrealestate.com.au)

<https://www.chapmanrealestate.com.au>

9 GUMNUT CLOSE, BLAXLAND

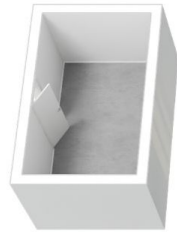

Lower Ground Floor



Ground Floor

INTERNAL
122 m²
EXTERNAL
62 m²
TOTAL
184 m²



The floor plan is not to scale; measurements are indicative and in metres. All features included in this 3D plan are for inspiration purposes only. This is not an exact replica of the property or the position of exterior elements. Plans should not be relied on. Interested parties should make and rely on their own enquiries.

9 GUMNUT CLOSE, BLAXLAND



Lower Ground Floor



(Not In Position)



Ground Floor

INTERNAL
122 m²
EXTERNAL
62 m²
TOTAL
184 m²



The floor plan is not to scale; measurements are indicative and in metres. Exterior elements are not in position. Plans should not be relied on. Interested parties should make and rely on their own enquiries.