



2 Sassafras Gully Road Springwood NSW

4 2 1

LOCATION - In one of Springwood's most tightly held locations, this home is set back on a flat garden block a short 800m stroll to all the amenity of Springwood village, with the fabulous Sassafras Gully bushwalk at the end of the street.

STYLE - This majority single level home (with loft) is of weatherboard construction with colorbond roof, dripping with the old world charm of a former miner's cottage built circa 1895, and retaining many of its original features.

LAYOUT - Flexible floorplan with a number of bedroom/living area options depending on resident need. What was originally a music room extension has been used as in-law accommodation/huge 4th bedroom with kitchenette and ensuite bathroom but could also be a living room or studio. There are three other bedrooms, a lounge

Type : House
Price : \$ 1,290,000
Land Size : 1283.6 sqm
View : <https://www.chapmanrealestate.com.au/sale/nsw/hawkesbury/springwood/residential/home/7277164>



Mark Poole
02 4751 8266

[For full version visit the website](https://www.chapmanrealestate.com.au)

<https://www.chapmanrealestate.com.au>

2 SASSAFRAS GULLY ROAD, SPRINGWOOD



First Floor

Ground Floor

INTERNAL
231 m²

EXTERNAL
75 m²

TOTAL
306 m²



The floor plan is not to scale; measurements are indicative and in metres. All features included in this 3D plan are for inspiration purposes only. This is not an exact replica of the property or the position of exterior elements. Plans should not be relied on. Interested parties should make and rely on their own enquiries.

2 SASSAFRAS GULLY ROAD, SPRINGWOOD

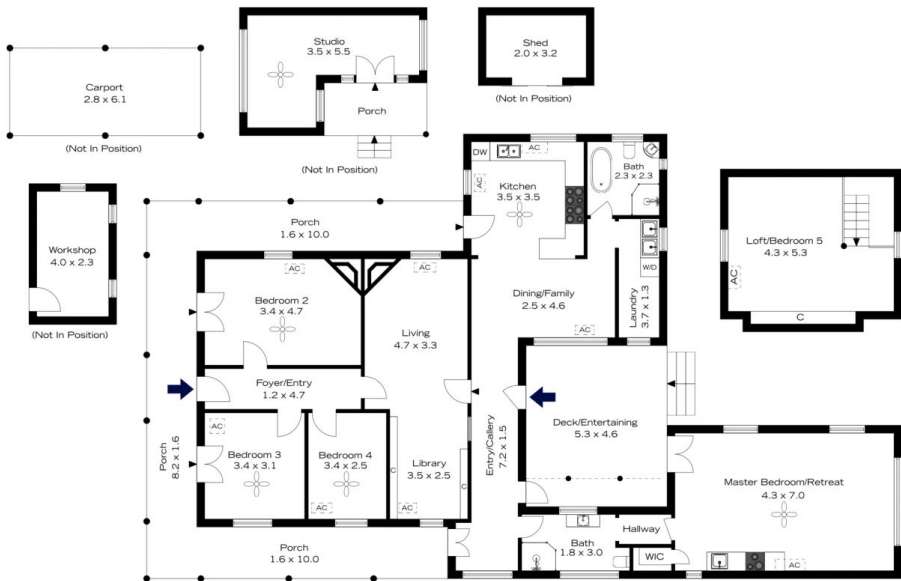

Ground Floor

INTERNAL
231 m²

EXTERNAL
75 m²

TOTAL
306 m²



The floor plan is not to scale; measurements are indicative and in metres. Exterior elements are not in position. Plans should not be relied on. Interested parties should make and rely on their own enquiries.