



#### 4 Bundah Street Winmalee NSW

4 1 1

**LOCATION** - Peacefully set in a quiet pocket of Winmalee just 100m to park, 700m to local shops, 2.5km to Winmalee Shopping Village and a 3.5km drive to Springwood village.

**STYLE** - Proudly high set home of brick construction and tile roof with garage underneath.

**LAYOUT** - Two separate living spaces both of generous proportions including light filled room overlooking the yard, four bedrooms in total - two with built in closets and one currently configured as home office, dining room off the kitchen and bathroom with separate toilet.

**FEATURES** - Updated kitchen with dishwasher, 900mm gas cooktop and stainless steel appliances open to dining room, slow combustion fireplace, gas heating and 2 x reverse cycle air conditioners, multiple ceiling fans, venetian blinds, landscaped yard front and back, gorgeous

**Type** : House  
**Price** : \$ 860,000  
**Land Size** : 720.8 sqm  
**View** : <https://www.chapmanrealestate.com.au/sale/nsw/hawkesbury/winmalee/residential/house/7266707>



**Mark Poole**  
02 4751 8266



**Claudia Hayes**  
02 4751 8266

[For full version visit the website](https://www.chapmanrealestate.com.au)

<https://www.chapmanrealestate.com.au>

# 4 BUNDAH STREET, WINMALEE



INTERNAL  
126 m<sup>2</sup>

EXTERNAL  
51 m<sup>2</sup>

TOTAL  
177 m<sup>2</sup>

The floor plan is not to scale; measurements are indicative and in metres. All features included in this 3D plan are for inspiration purposes only. This is not an exact replica of the property or the position of exterior elements. Plans should not be relied on. Interested parties should make and rely on their own enquiries.

# 4 BUNDAH STREET, WINMALEE

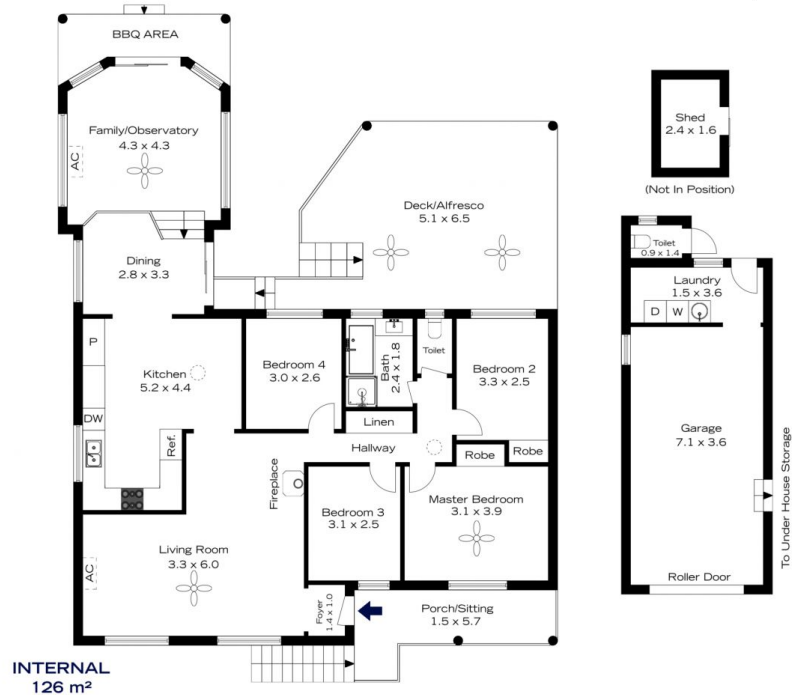

INTERNAL  
126 m<sup>2</sup>

EXTERNAL  
51 m<sup>2</sup>

TOTAL  
177 m<sup>2</sup>

The floor plan is not to scale; measurements are indicative and in metres. Exterior elements are not in position. Plans should not be relied on. Interested parties should make and rely on their own enquiries.