



100 Glenbrook Road Glenbrook NSW

4 2 2

LOCATION: Conveniently positioned within a short 400m (approx.) walk to Glenbrook Lagoon and Lennox Park, within 4 mins drive to local preschool, primary & high schools, playgrounds, ovals, tennis courts, cinema, pool, pub, rail, walking trails, Glenbrook village as well as Brooklands & Blaxland shops, and easy access to Emu Plains & Penrith via Mitchells Pass.

STYLE: High set, two storey, spacious family home of brick and clad construction with tile roof, lovely mountain views on a 1391sqm (approx.) natural bush block backing Mount Sion. First time offered to market.

LAYOUT: Entry level includes the sunlit combined living and dining room, amazing conservatory style enclosed sunroom extending your indoor living, 3 bedrooms (2 with built-in robes) and main bathroom with separate toilet.

Type : House
Price : \$ 990,000
Land Size : 1391 sqm
View : <https://www.chapmanrealestate.com.au/sale/nsw/blue-mountains-surrounds/glenbrook/residential/house/7171780>



Glen Power
02 4739 4311



Claudia Hayes
02 4751 8266

[For full version visit the website](https://www.chapmanrealestate.com.au)

100 GLENBROOK ROAD, GLENBROOK



Ground Floor

INTERNAL
214 m²

EXTERNAL
4 m²

TOTAL
218 m²



Lower Floor

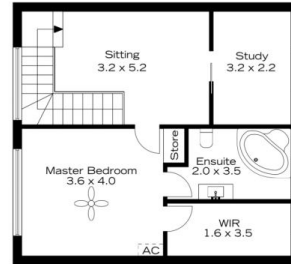

First Floor



The floor plan is not to scale; measurements are indicative and in metres. Exterior elements are not in position. Plans should not be relied on. Interested parties should make and rely on their own enquiries.

100 GLENBROOK ROAD, GLENBROOK



Ground Floor

INTERNAL
214 m²

EXTERNAL
4 m²

TOTAL
218 m²

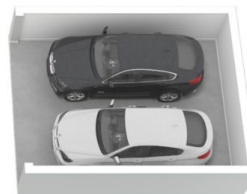

Lower Floor



First Floor



The floor plan is not to scale; measurements are indicative and in metres. All features included in this 3D plan are for inspiration purposes only. This is not an exact replica of the property or the position of exterior elements. Plans should not be relied on. Interested parties should make and rely on their own enquiries.