

126 Grose Road Faulconbridge NSW

5 2 3

LOCATION - Beautifully positioned in sought after Faulconbridge with an exquisite and mainly un-interrupted valley view, walking distance (approx. 450m) to local high school & bus stop, 2.6km to train, easy access to highway, close to bush walks and moments to famous Norman Lindsay Gallery & Cafe.

STYLE - Two storey mainly brick home with colour bond roof on approximately 1461m2 block.

LAYOUT - Impressive entrance down hallway into large open plan living space which flows outdoors onto large entertaining area with magnificent views, additional separate home office area and music room, 5 upstairs bedrooms including master with ensuite and walk in robe, 3 additional upstairs bedrooms with built ins and access to generous family bathroom with claw foot bath and double

[For full version visit the website](#)

Type : House
Price : \$ 1,190,000
Land Size : 1461 sqm
View : <https://www.chapmanrealestate.com.au/sale/nsw/hawkesbury/faulconbridge/residential/house/7161605>



Helen Harris
02 4751 8266



Claudia Hayes
02 4751 8266

126 GROSE ROAD, FAULCONBRIDGE



First Floor

Ground Floor

INTERNAL
197 m²

EXTERNAL
30 m²

TOTAL
227 m²



The floor plan is not to scale; measurements are indicative and in metres. All features included in this 3D plan are for inspiration purposes only. This is not an exact replica of the property or the position of exterior elements. Plans should not be relied on. Interested parties should make and rely on their own enquiries.

126 GROSE ROAD, FAULCONBRIDGE

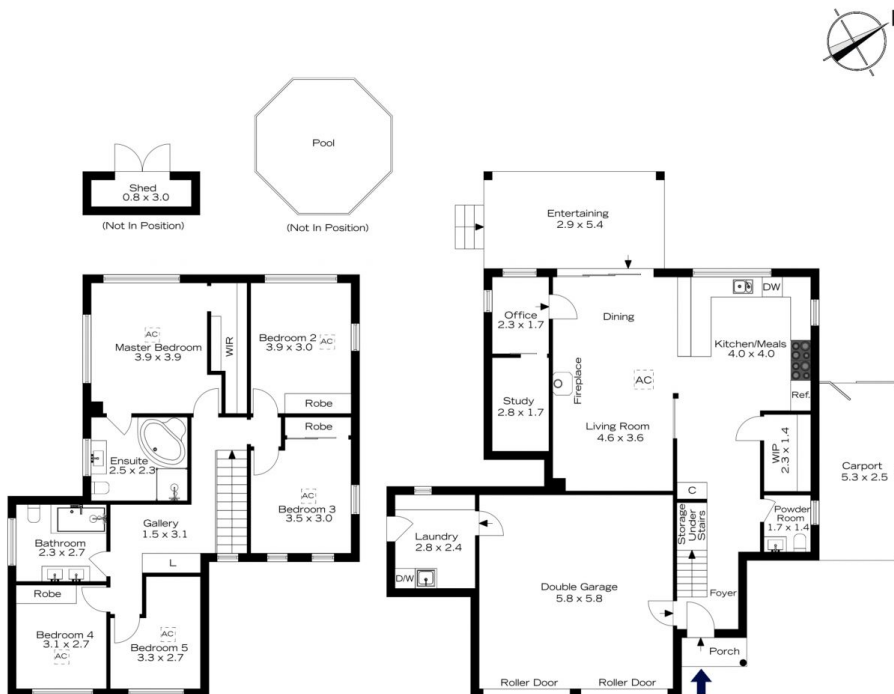

First Floor

Ground Floor

INTERNAL
197 m²

EXTERNAL
30 m²

TOTAL
227 m²



The floor plan is not to scale; measurements are indicative and in metres. Exterior elements are not in position. Plans should not be relied on. Interested parties should make and rely on their own enquiries.