



## 48 Dawn Crescent Mount Riverview NSW

5 3 2

**LOCATION** - Quality location within short stroll to public school (shortcut from rear), restaurant, bus, local supermarket, tranquil bush walks and children's playground.

**STYLE** - Majestic 2 storey brick family residence with attractive lifestyle appeal, offering - sparkling in-ground pool and spa, bushland views, large useable yard and huge covered entertainers paved alfresco.

**LAYOUT** - 3 living rooms, dining room, high raked ceilings in main living, 5 bedrooms, updated ensuite and walk in robe off master, 3 bathrooms.

**FEATURES** - Open plan kitchen, great sized rooms, freshly painted, reverse cycle air conditioning, gas bayonet, downlights, bay window, level access from house to rear, ceiling fan, extra air conditioning in 3 bedrooms, cubby

**Type** : House  
**Price** : \$ 1,220,000  
**Land Size** : 835 sqm  
**View** : <https://www.chapmanrealestate.com.au/sale/nsw/hawkesbury/mount-riverview/residential/house/7161576>

[For full version visit the website](https://www.chapmanrealestate.com.au)



**Milton Player**  
02 4739 4311



**Glen Power**  
02 4739 4311

# 48 DAWN CRESCENT, MOUNT RIVERVIEW

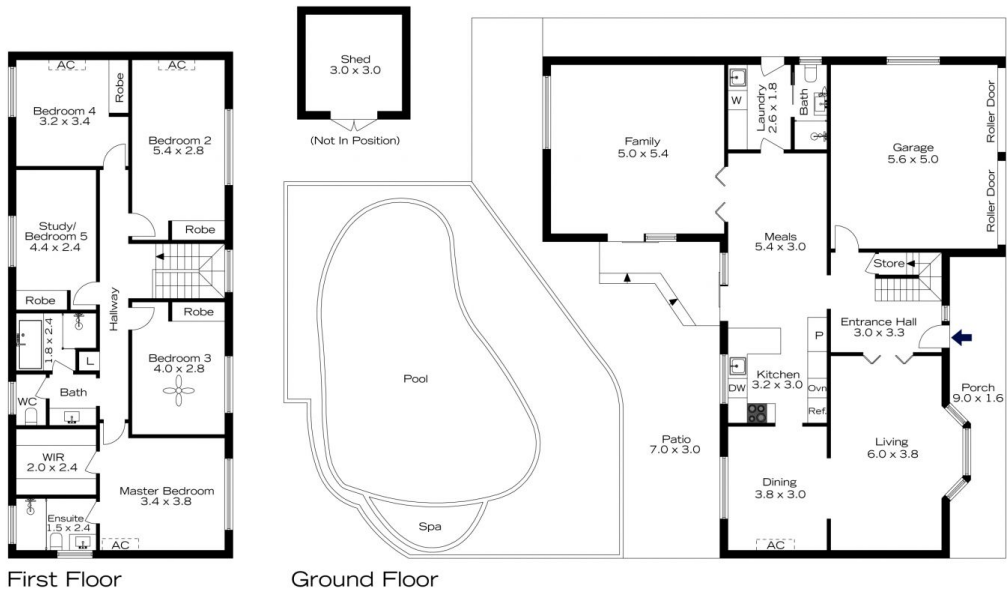

The floor plan is not to scale; measurements are indicative and in metres. Exterior elements are not in position. Plans should not be relied on. Interested parties should make and rely on their own enquiries.

# 48 DAWN CRESCENT, MOUNT RIVERVIEW



The floor plan is not to scale; measurements are indicative and in metres. All features included in this 3D plan are for inspiration purposes only. This is not an exact replica of the property or the position of exterior elements. Plans should not be relied on. Interested parties should make and rely on their own enquiries.