



#### 4 Homedale Street Springwood NSW

4 🚗 1 🚻 3 🚗

**LOCATION** - Highly regarded as one of the best locations in Springwood Village, just a gentle walk (approx. 450m) to train, village, cafes, restaurants, specialty stores and main street attractions with bus stop at your door step.

**STYLE** - High-set single level clad cottage with colourbond roof, currently operating as medical practices servicing both orthodontist and consultancy rooms.

**LAYOUT** - Waiting room and reception could be lounge/dining, 4 generous consulting rooms or bedrooms, kitchen area, bathroom, laundry, double carport and single garage.

**FEATURES** - Off street parking for 4 vehicles including disabled parking, ducted air-conditioning, well maintained throughout, can be sold with all equipment, great location easy access to Springwood village, approved for medical use (orthodontist). Rare opportunity not only for business use (medical) also a great location for a home.

**Price** : \$ 1,235,000  
**Land Size** : 682.9 sqm  
**View** : <https://www.chapmanrealestate.com.au/sale/nsw/hawkesbury/springwood/residential/home/7161533>



**Jonathan Crisp**  
02 4751 8266

# 4 HOMEDALE STREET, SPRINGWOOD



**INTERNAL**  
126 m<sup>2</sup>

**EXTERNAL**  
17 m<sup>2</sup>

**TOTAL**  
143 m<sup>2</sup>



The floor plan is not to scale; measurements are indicative and in metres. All features included in this 3D plan are for inspiration purposes only. This is not an exact replica of the property or the position of exterior elements. Plans should not be relied on. Interested parties should make and rely on their own enquiries.

# 4 HOMEDALE STREET, SPRINGWOOD

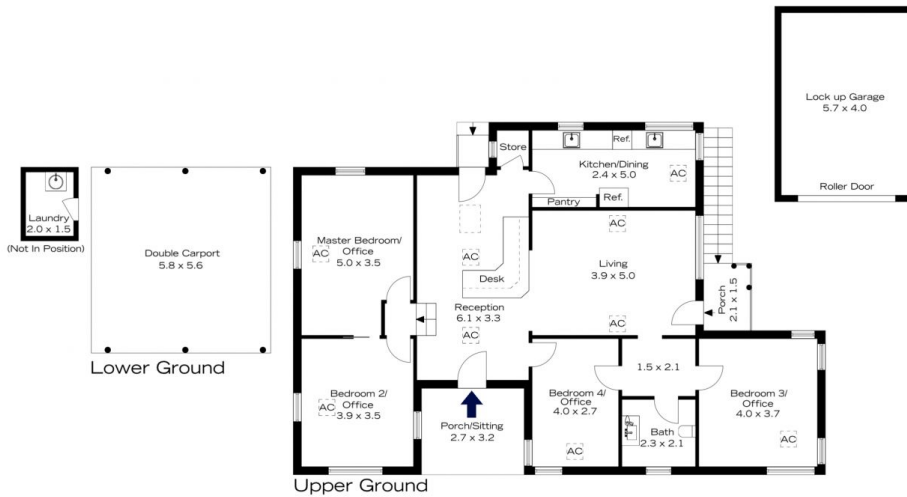

**INTERNAL**  
126 m<sup>2</sup>

**EXTERNAL**  
17 m<sup>2</sup>

**TOTAL**  
143 m<sup>2</sup>



The floor plan is not to scale; measurements are indicative and in metres. Exterior elements are not in position. Plans should not be relied on. Interested parties should make and rely on their own enquiries.