



## 20 Allen Street Blaxland NSW

5 2 2

**LOCATION** - This stunning residence is only 8 years old, and located in a highly sought-after estate, surrounded by recent builds. Positioned only moments from Mitchell's Pass, there is a quick and direct route straight into Emu Plains and the Penrith CBD from this lower Mountains home. The Great Western Highway is only a few minutes by car. Shops, cafes, and restaurants are all within a few moments' drive. There is easy access to East Blaxland shops, as well as Blaxland Shopping Village and Blaxland Station is conveniently located only 1.3km away. Schools, parks, post office, bush walks and day-care options are all within a few minutes' drive of this residence.

**STYLE** - This exciting property has been styled with a modern elegance, meaning there is absolutely nothing to

[For full version visit the website](https://www.chapmanrealestate.com.au)

**Type** : House  
**Price** : \$ 1,570,000  
**Land Size** : 722 sqm  
**View** : <https://www.chapmanrealestate.com.au/sale/nsw/blue-mountains-surrounds/blaxland/residential/house/7161489>



**Chris Rayner**  
02 4739 6200



**Glen Power**  
02 4739 4311



Internal Area : 250 sqm approx.  
External Area : 77 sqm approx.  
Total Area : 327 sqm approx.



Ground Floor



First Floor

The floor plan is not to scale; measurements are indicative and in metres. All features included in this 3D plan are for inspiration purposes only. This is not an exact replica of the property or the position of exterior elements. Plans should not be relied on. Interested parties should make and rely on their own enquiries.

Produced by DIAKRIT

20 Allen Street, Blaxland

Chapman

Internal Area : 250 sqm approx.  
External Area : 77 sqm approx.  
Total Area : 327 sqm approx.



Ground Floor

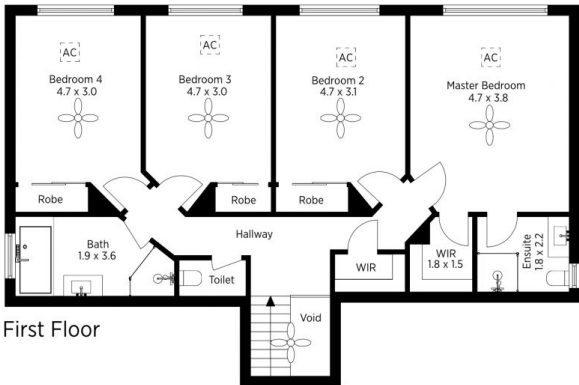

First Floor

The floor plan is not to scale; measurements are indicative and in metres. Exterior elements are not in position. Plans should not be relied on. Interested parties should make and rely on their own enquiries.

Produced by DIAKRIT

20 Allen Street, Blaxland

Chapman