

2A Koala Road Blaxland NSW

2 1 1

LOCATION - Enjoy the serenity in this sought-after lower Mountains location. This north-facing property is bathed in sunlight and is conveniently located moments from shops, schools, parks, scenic bushwalks, and public transport.

STYLE - This charming cottage-style home is packed with potential. The rustic timber flooring flows throughout the home. Styled with a neutral colour palette, timber wall panels, and picture rails, the original features give the home a sense of character. The home is awash with natural light in every room.

LAYOUT - This two-bedroom home has a floor plan that offers flexibility. This property offers an open plan kitchen and combined dining room, with an adjoining lounge room.

[For full version visit the website](https://www.chapmanrealestate.com.au)

Type : House
Price : \$ 920,000
Land Size : 746 sqm
View : <https://www.chapmanrealestate.com.au/sale/nsw/blue-mountains-surrounds/blaxland/residential/house/7161485>



Kate Spence
02 4739 6200



Chris Rayner
02 4739 6200

2A KOALA ROAD, BLAXLAND



INTERNAL
92 m²

EXTERNAL
69 m²

TOTAL
161 m²



The floor plan is not to scale; measurements are indicative and in metres. All features included in this 3D plan are for inspiration purposes only. This is not an exact replica of the property or the position of exterior elements. Plans should not be relied on. Interested parties should make and rely on their own enquiries.

2A KOALA ROAD, BLAXLAND

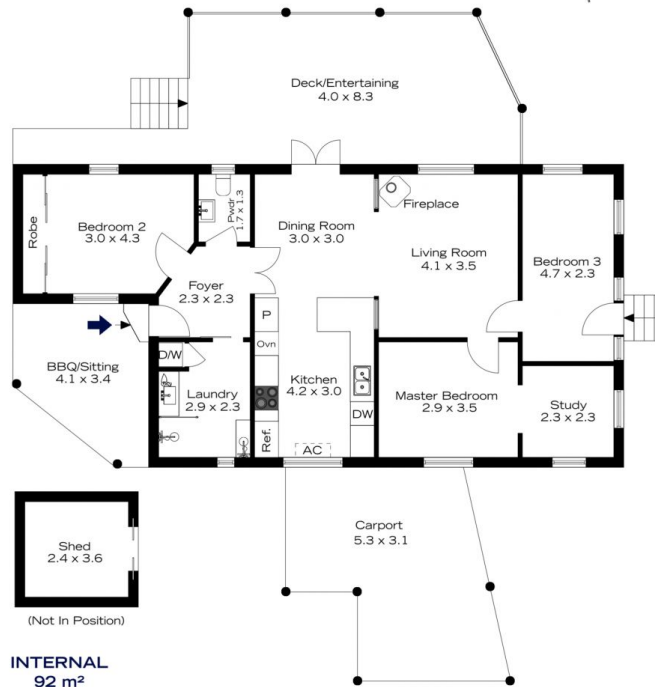

INTERNAL
92 m²

EXTERNAL
69 m²

TOTAL
161 m²



The floor plan is not to scale; measurements are indicative and in metres. Exterior elements are not in position. Plans should not be relied on. Interested parties should make and rely on their own enquiries.