



18 Murphy Street Blaxland NSW

3 1 1

LOCATION- This magnificent cottage is tucked away behind the picturesque white picket fence and moments to local shops, parks, high performing local schools and Blaxland main shopping centre, train station, Glenbrook Lagoon and Glenbrook pool all within 1.5km. A perfect blend of lifestyle and convenience.

STYLE- Absolutely adorable is the character cottage with tile roof. This home embraces the checklist of features people desire to find in the lower Blue Mountains.

ACCOMODATION- Promoting a comfortable layout with plenty of opportunity to enjoy the seamless flow throughout. There are 3 bedrooms, a nice size open plan living and dining area and an easy to work with floorplan. Sitting on a

[For full version visit the website](https://www.chapmanrealestate.com.au)

Type : House
Price : \$ 847,250
Land Size : 643 sqm
View : <https://www.chapmanrealestate.com.au/sale/nsw/blue-mountains-surrounds/blaxland/residential/house/7161475>



Chris Rayner
02 4739 6200



Sharon Lampert
02 4739 4311

Internal Area : 88 sqm approx.
 External Area : 2 sqm approx.
 Total Area : 90 sqm approx.



The floor plan is not to scale; measurements are indicative and in metres. All features included in this 3D plan are for inspiration purposes only. This is not an exact replica of the property or the position of exterior elements. Plans should not be relied on. Interested parties should make and rely on their own enquiries.

Produced by **DIAKRIT**

18 Murphy Street, Blaxland

Chapman

Internal Area : 88 sqm approx.
 External Area : 2 sqm approx.
 Total Area : 90 sqm approx.

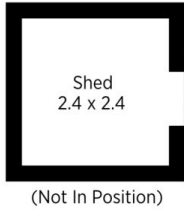
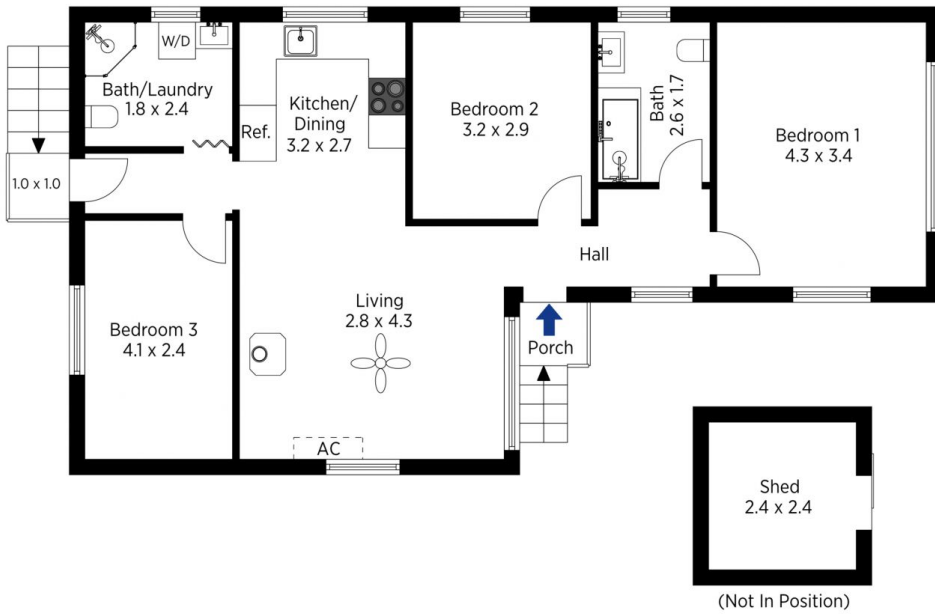

The floor plan is not to scale; measurements are indicative and in metres. Exterior elements are not in position. Plans should not be relied on. Interested parties should make and rely on their own enquiries.

Produced by **DIAKRIT**

18 Murphy Street, Blaxland

Chapman