

30 Ranch Avenue Glenbrook NSW

3 2 2

LOCATION - Set on a large gently sloping block of approx. 904m². Nestled between the village and national park, you can enjoy all Glenbrook has to offer including cafes, cinema, parks, schools, tennis courts, swimming pool & rail/bus services. Discover the Blue Mountains National Park with the entrance a mere 350 metres (approx.) from your door, the entry way to natural swimming holes, Red Hands cave, camping grounds, BBQ areas, hikes & trails.

STYLE - Modern and stylish, single level, rendered cottage with Colourbond roof. Positioned toward the front of the block offering full use of the expansive, park-like grounds at the back.

LAYOUT - The open plan L shape living, dining & kitchen provides effortless flow onto the elevated entertainers deck at the rear. 3 bedrooms (2 with built-in robes), modern

Type : House
Price : \$ 1,228,000
Land Size : 904.2 sqm
View : <https://www.chapmanrealestate.com.au/sale/nsw/blue-mountains-surrounds/glenbrook/residential/house/7161452>



Sarah Watson
02 4739 4311

[For full version visit the website](https://www.chapmanrealestate.com.au)

<https://www.chapmanrealestate.com.au>

30 RANCH AVENUE, GLENBROOK



Ground Floor



(Not in Position)

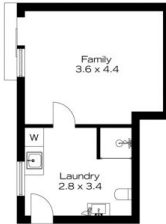

Lower Ground Floor

INTERNAL
124 m²
EXTERNAL
80 m²
TOTAL
204 m²



The floor plan is not to scale; measurements are indicative and in metres. Exterior elements are not in position. Plans should not be relied on. Interested parties should make and rely on their own enquiries.

30 RANCH AVENUE, GLENBROOK



Ground Floor



Lower Ground Floor

INTERNAL
124 m²
EXTERNAL
80 m²
TOTAL
204 m²



The floor plan is not to scale; measurements are indicative and in metres. All features included in this 3D plan are for inspiration purposes only. This is not an exact replica of the property or the position of exterior elements. Plans should not be relied on. Interested parties should make and rely on their own enquiries.