



9 Myall Avenue Leura NSW

2 1 1

LOCATION - Set amongst the bush this quaint mountains cottage is within 1.3kms of the popular cafes, shops, services and rail station of Leura village.

STYLE - Updated single level clad cottage with metal roof, set on a lovely 967m2 (approx) bush block.

LAYOUT - Open plan living/dining, spacious modern kitchen, 2 bedrooms, renovated bathroom and large deck for entertaining. Off street parking for 2 or more cars.

FEATURES - Charm of the Blue Mountains, this 1950's cottage has benefited from an upgrade to include a modern new kitchen, complete with stone bench tops, dishwasher, stainless steel oven, rangehood and gas cooktop. Natural light floods in through the 2 large roof skylights. Decks at the front and back, with french doors leading out, overlooking the bush back drop. Fully renovated bathroom with walk in shower.

Price : \$ 665,000

Land Size : 967 sqm

View : <https://www.chapmanrealestate.com.au/sale/nsw/blue-mountains-surrounds/leura/residential/house/7161442>



James Simadas
02 4782 5045



Hayley Clifton
02 4782 5045



The floor plan is not to scale; measurements are indicative and in metres. All features included in this 3D plan are for inspiration purposes only. This is not an exact replica of the property or the position of exterior elements. Plans should not be relied on. Interested parties should make and rely on their own enquiries.

Produced by DIAKRIT

9 Myall Avenue, Leura

Chapman

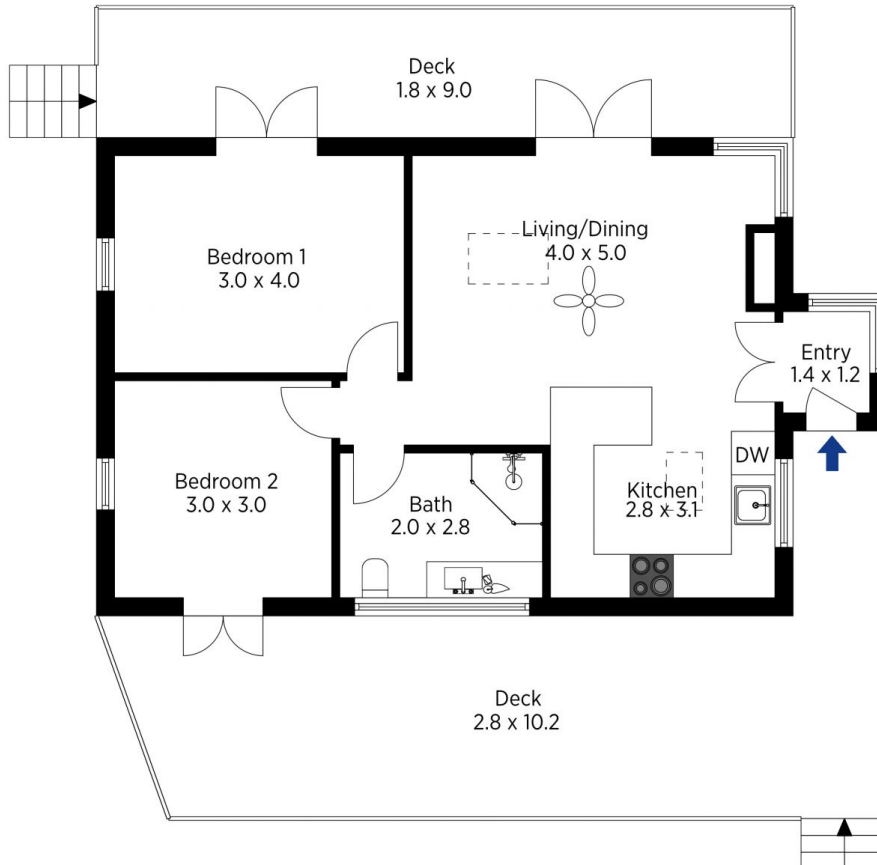

The floor plan is not to scale; measurements are indicative and in metres. Exterior elements are not in position. Plans should not be relied on. Interested parties should make and rely on their own enquiries.

Produced by DIAKRIT

9 Myall Avenue, Leura

Chapman