



182 Rusden Road Mount Riverview NSW

4 1 1

LOCATION - Conveniently located with easy stroll to local shops, cafe, church, childcare, school and bus along with close by popular bushwalks.

STYLE - Single level brick and tile home on a 701.9m2 private corner block.

LAYOUT - Generous open plan living/dining area, 4 bedrooms, updated 3 way bathroom with shower over large corner bath, two toilets, ample off street parking along with lock up carport.

FEATURES - Updated kitchen with stone benches and stainless steel appliances, generous amount of cupboards, timber flooring throughout, fans, built-ins, reverse cycle air conditioning, easy care level backyard, paved firepit entertaining area, rear deck off living area, vegie garden, fenced landscaped yard with large lockable shed tucked out of sight.

Price : \$ 905,000

Land Size : 701.9 sqm

View : <https://www.chapmanrealestate.com.au/sale/nsw/hawkesbury/mount-riverview/residential/house/7161441>



Jonathan Crisp
02 4751 8266



Kate Spence
02 4739 6200

182 RUSDEN ROAD, MOUNT RIVERVIEW



INTERNAL
120 m²
EXTERNAL
43 m²
TOTAL
163 m²



The floor plan is not to scale; measurements are indicative and in metres. All features included in this 3D plan are for inspiration purposes only. This is not an exact replica of the property or the position of exterior elements. Plans should not be relied on. Interested parties should make and rely on their own enquiries.

182 RUSDEN ROAD, MOUNT RIVERVIEW

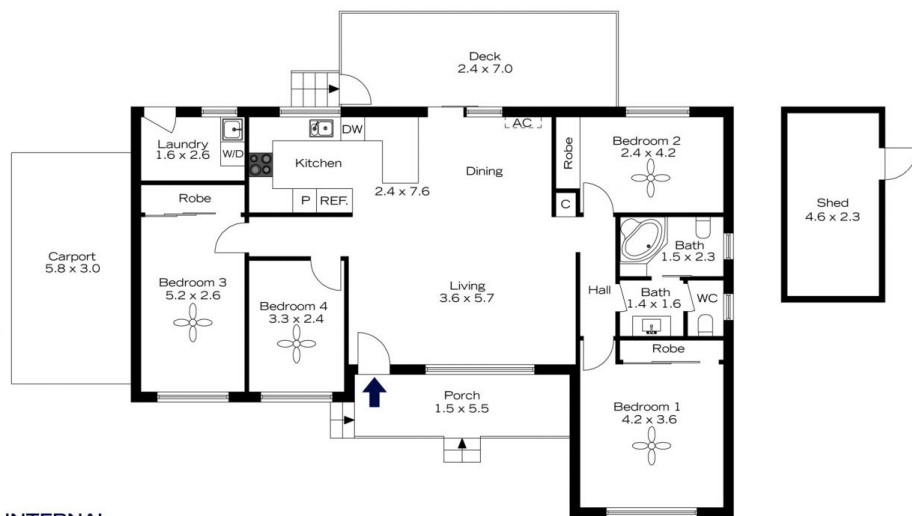

INTERNAL
120 m²
EXTERNAL
43 m²
TOTAL
163 m²



The floor plan is not to scale; measurements are indicative and in metres. Exterior elements are not in position. Plans should not be relied on. Interested parties should make and rely on their own enquiries.