



109 Governors Drive Lapstone NSW

3 1 1

LOCATION: Located on a tree-lined street in a tranquil and highly desired pocket of Lapstone. Nestled amongst bush walks, bike tracks, netball & tennis courts, oval, park, Lapstone Public School & Preschool, bus and rail (all within approx. 850m), a short 3 min drive to Glenbrook village with its shops and cafes, and convenient access to M4 motorway.

STYLE: Single level brick and tile home positioned on a stunning bush block of approximately 916qm offering an elevated, incredible vista of Darks Common.

LAYOUT: 2 living rooms, 3 bedrooms (master with built in robe), full bathroom, handy separate 2nd toilet, laundry with external access.

FEATURES: Well-appointed timber kitchen with granite benches, wooden breakfast bar, stainless steel appliances

Type : House
Price : \$ 1,050,000
Land Size : 916 sqm
View : <https://www.chapmanrealestate.com.au/sale/nsw/blue-mountains-surrounds/lapstone/residential/house/7161426>



Glen Power
02 4739 4311

[For full version visit the website](https://www.chapmanrealestate.com.au)

109 GOVERNORS DRIVE, LAPSTONE

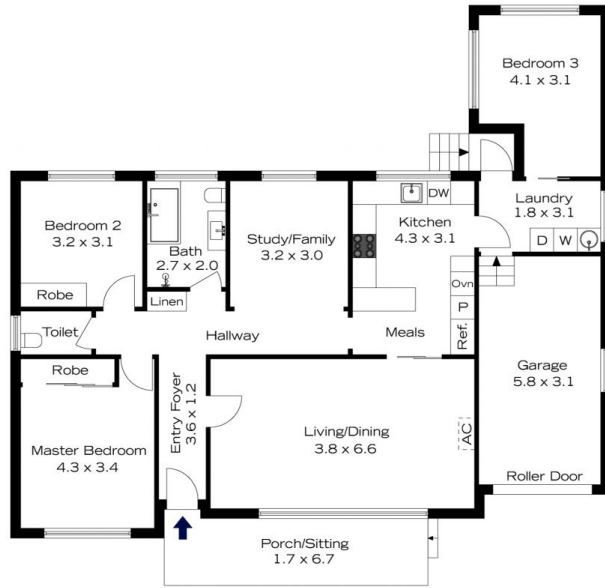

INTERNAL
133 m²
EXTERNAL
13 m²
TOTAL
146 m²



The floor plan is not to scale; measurements are indicative and in metres. Exterior elements are not in position. Plans should not be relied on. Interested parties should make and rely on their own enquiries.

109 GOVERNORS DRIVE, LAPSTONE



INTERNAL
133 m²
EXTERNAL
13 m²
TOTAL
146 m²



The floor plan is not to scale; measurements are indicative and in metres. All features included in this 3D plan are for inspiration purposes only. This is not an exact replica of the property or the position of exterior elements. Plans should not be relied on. Interested parties should make and rely on their own enquiries.