



7 Illingworth Road Yellow Rock NSW

4 2 2

LOCATION - Situated in the peaceful community of Yellow Rock, convenient to bus, on a flat and accessible block.

STYLE - Single level Beechwood home of brick construction with tile roof.

LAYOUT - Separate living spaces including formal lounge, family/dining and rumpus room, four bedrooms including main with ensuite bathroom, main bathroom with corner bath, heated towel rails.

FEATURES - Kitchen with breakfast bar and dishwasher, open to family/dining space, downlights, ducted AC, ceiling fans, natural gas, ducted vacuum, large undercover deck flowing to grassy fully fenced rear yard, double garage.

Disclaimer:

All information contained herein is gathered from sources

[For full version visit the website](https://www.chapmanrealestate.com.au)

Type : House
Price : \$ 660,000
Land Size : 771.4 sqm
View : <https://www.chapmanrealestate.com.au/sale/nsw/hawkesbury/yellow-rock/residential/home/7161355>



Mark Poole
02 4751 8266



Jonathan Crisp
02 4751 8266



The floor plan is not to scale; measurements are indicative and in metres. All features included in this 3D plan are for inspiration purposes only. This is not an exact replica of the property or the position of exterior elements. Plans should not be relied on. Interested parties should make and rely on their own enquiries.

Produced by DIAKRIT

7 Illingworth Road, Yellow Rock

Chapman

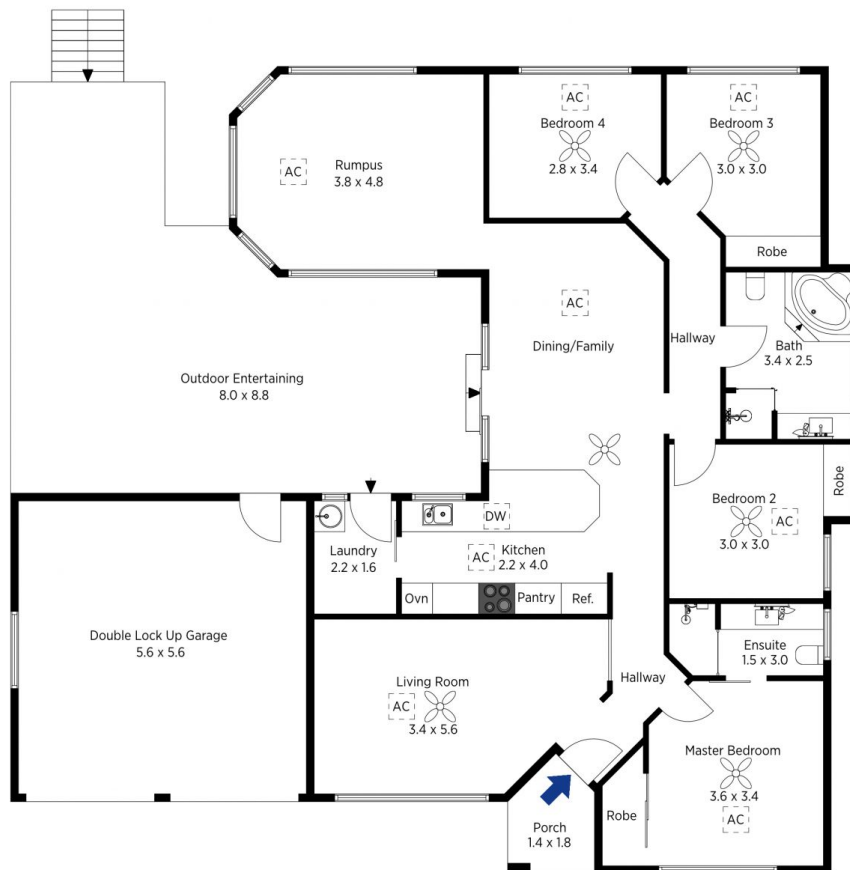

The floor plan is not to scale; measurements are indicative and in metres. Exterior elements are not in position. Plans should not be relied on. Interested parties should make and rely on their own enquiries.

Produced by DIAKRIT

7 Illingworth Road, Yellow Rock

Chapman