



14 Pellion Street Blaxland NSW

3 1 2

LOCATION: Nestled on a low maintenance block of approx 519sqm, moments to gymnasium, St Johns oval, basket ball courts and kids play area. Near level walk of under (2km) to Blaxland CBD and rail, public bus stop located approx 650m on highway.

STYLE: Single level clad cottage with tile roof, built approximately late 1960's / early 70's, offering low maintenance living.

LAYOUT: Uncomplicated floor plan with spacious living room, separate meals area, 3 bedrooms of generous size (2 w/ built in robes), bathroom, internal laundry, separate studio ideal as craft / arts room or potential guest room.

FEATURES: Horseshoe kitchen layout with open servery window & backyard aspect, air conditioning, gas bayonet for heating, polished timber floors, timber windows, 9ft

Type : House
Price : \$ 640,000
Land Size : 519 sqm
View : <https://www.chapmanrealestate.com.au/sale/nsw/blue-mountains-surrounds/blaxland/residential/house/7161259>



Milton Player
02 4739 4311



Tennille Haddock
02 4739 4311

[For full version visit the website](https://www.chapmanrealestate.com.au)

<https://www.chapmanrealestate.com.au>

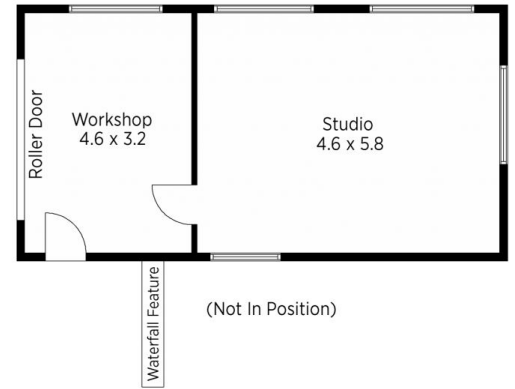
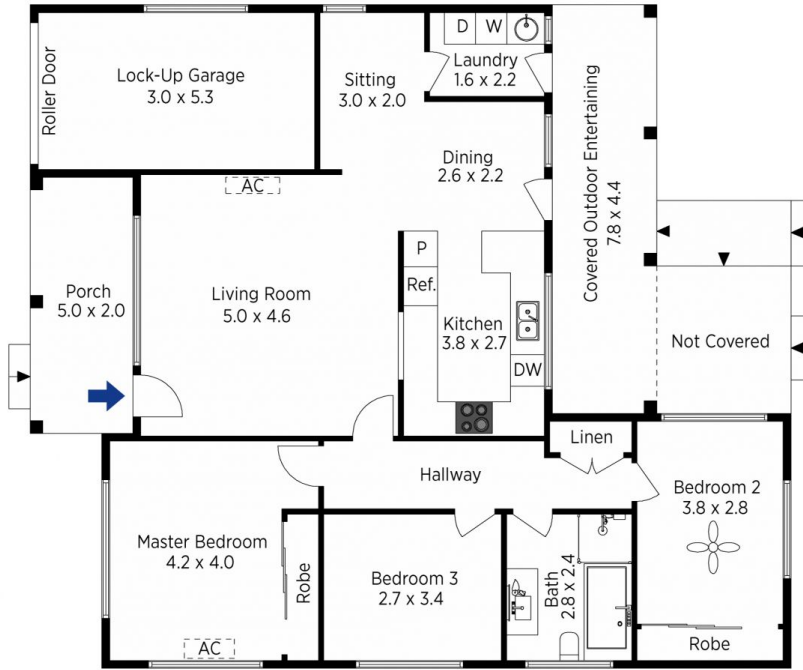
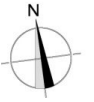

The floor plan is not to scale; measurements are indicative and in metres. Exterior elements are not in position. Plans should not be relied on. Interested parties should make and rely on their own enquiries.

Produced by DIAKRIT

14 Pellion St, Blaxland

Chapman

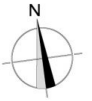

The floor plan is not to scale; measurements are indicative and in metres. All features included in this 3D plan are for inspiration purposes only. This is not an exact replica of the property or the position of exterior elements. Plans should not be relied on. Interested parties should make and rely on their own enquiries.

Produced by DIAKRIT

14 Pellion St, Blaxland

Chapman