



251 Hawkesbury Road Winmalee NSW

3 1 2

LOCATION - With a sunny northerly aspect and set well back from the road on a very flat block with gradual slope to rear, just 180m to local shops, 1.7km to Winmalee Shopping Village and within 2.3km of schools, parks, and golf course.

STYLE - Single level vinyl clad cottage with tile roof built in 1962, proudly called home by the one owner for the last 59 years.

LAYOUT - Generous light filled living room, sunrooms at the front and rear, three bedrooms all with built in closets, updated bathroom with separate toilet and 2nd "gardeners toilet" outside.

FEATURES - Centrally located kitchen overlooking rear sunroom and backyard, reverse cycle air conditioning, 2x ceiling fans, gas heater, 20 panel solar system, 3x water

Type : House
Price : \$ 831,444
Land Size : 1195 sqm
View : <https://www.chapmanrealestate.com.au/sale/nsw/hawkesbury/winmalee/residential/house/7161230>



Mark Poole
02 4751 8266

[For full version visit the website](https://www.chapmanrealestate.com.au)

Internal Area : 181 sqm approx.
 External Area : 56 sqm approx.
 Total Area : 237 sqm approx.

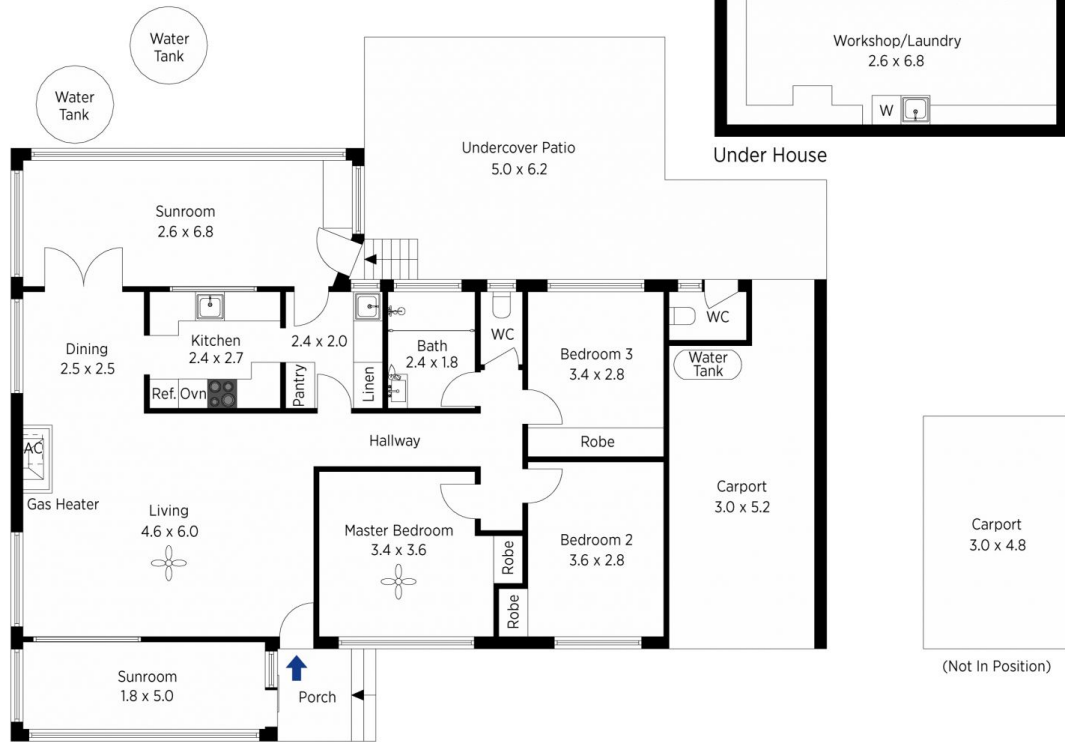

The floor plan is not to scale; measurements are indicative and in metres. Exterior elements are not in position. Plans should not be relied on. Interested parties should make and rely on their own enquiries.

Produced by DIAKRIT

251 Hawkesbury Road, Winmalee

Chapman

Internal Area : 181 sqm approx.
 External Area : 56 sqm approx.
 Total Area : 237 sqm approx.



The floor plan is not to scale; measurements are indicative and in metres. All features included in this 3D plan are for inspiration purposes only. This is not an exact replica of the property or the position of exterior elements. Plans should not be relied on. Interested parties should make and rely on their own enquiries.

Produced by DIAKRIT

251 Hawkesbury Road, Winmalee

Chapman