



6 Evans Parade Lapstone NSW

3 2 1

LOCATION - Peaceful, sought after pocket of Lapstone. Set back from the road behind mature plantings on a block of approx. 708sqm. Conveniently positioned a mere 700m approx. to rail.

STYLE - Comfortable and tranquil brick and tile home providing light-filled living spaces and elevated easterly views from the rear.

LAYOUT - Offering a versatile floor plan with multiple living rooms, 4 bedrooms, built-in robes to all rooms, 4th bedroom ideal as a teenager's retreat or guest accommodation with powder room, 1.5 bathrooms overall.

FEATURES - Modern galley style kitchen, split system air conditioning, high ceilings, downlights, bay windows, bull-nosed verandah, front terrace, fenced rear yard, inground pool, lock-up garage.

Type : House
Price : \$ 795,000
Land Size : 708 sqm
View : <https://www.chapmanrealestate.com.au/sale/nsw/blue-mountains-surrounds/lapstone/residential/house/7161192>



Milton Player
02 4739 4311



Tennille Haddock
02 4739 4311

[For full version visit the website](https://www.chapmanrealestate.com.au)

<https://www.chapmanrealestate.com.au>



The floor plan is not to scale; measurements are indicative and in metres. All features included in this 3D plan are for inspiration purposes only. This is not an exact replica of the property or the position of exterior elements. Plans should not be relied on. Interested parties should make and rely on their own enquiries.

Produced by DIAKRIT

6 Evans Parade, Lapstone

Chapman

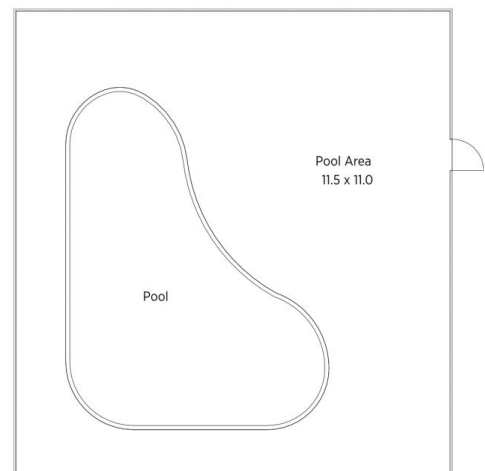
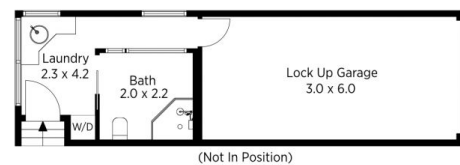

The floor plan is not to scale; measurements are indicative and in metres. Exterior elements are not in position. Plans should not be relied on. Interested parties should make and rely on their own enquiries.

Produced by DIAKRIT

6 Evans Parade, Lapstone

Chapman