



78 Birdwood Avenue Winmalee NSW

3 1 4

LOCATION - Peaceful cul de sac location, close to schools & bus, with easy access to both Springwood & Winmalee.

STYLE - Single level brick, clad & tile home with large separate approx. 4 (small) car garage all on a 2061 m2 block.

LAYOUT - Generous L shape lounge/dining, 3 beds, 2 with built ins, large bathroom with corner bath, generous kitchen, access to rear deck.

FEATURES - Timber floors, side access, under house storage, reverse cycle air conditioning, modern styling throughout, large yard with grassy areas, backs bushland, portion of yard fenced. Great first home with bonus huge workshop/garage. Beat the proposed election changes!

Disclaimer: All information contained herein is gathered

[For full version visit the website](https://www.chapmanrealestate.com.au)

Type : House
Price : \$ 565,000
Land Size : 2061 sqm
View : <https://www.chapmanrealestate.com.au/sale/nsw/hawkesbury/winmalee/residential/house/7161154>



Jonathan Crisp
02 4751 8266



Claudia Hayes
02 4751 8266



The floor plan is not to scale; measurements are indicative and in metres. All features included in this 3D plan are for inspiration purposes only. This is not an exact replica of the property or the position of exterior elements. Plans should not be relied on. Interested parties should make and rely on their own enquiries.

Produced by DIAKRIT

78 Birdwood Avenue, Winmalee

Chapman

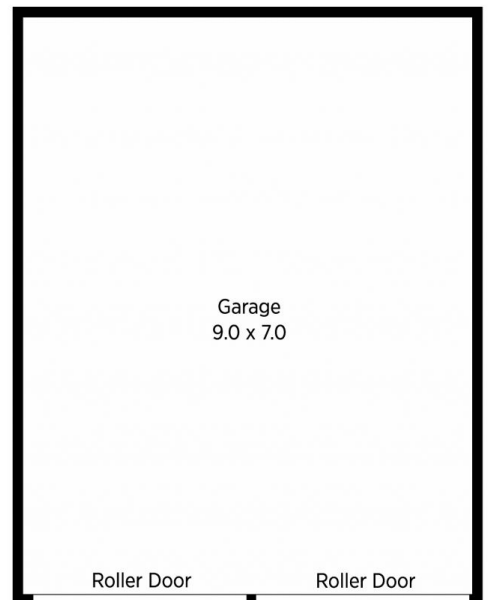
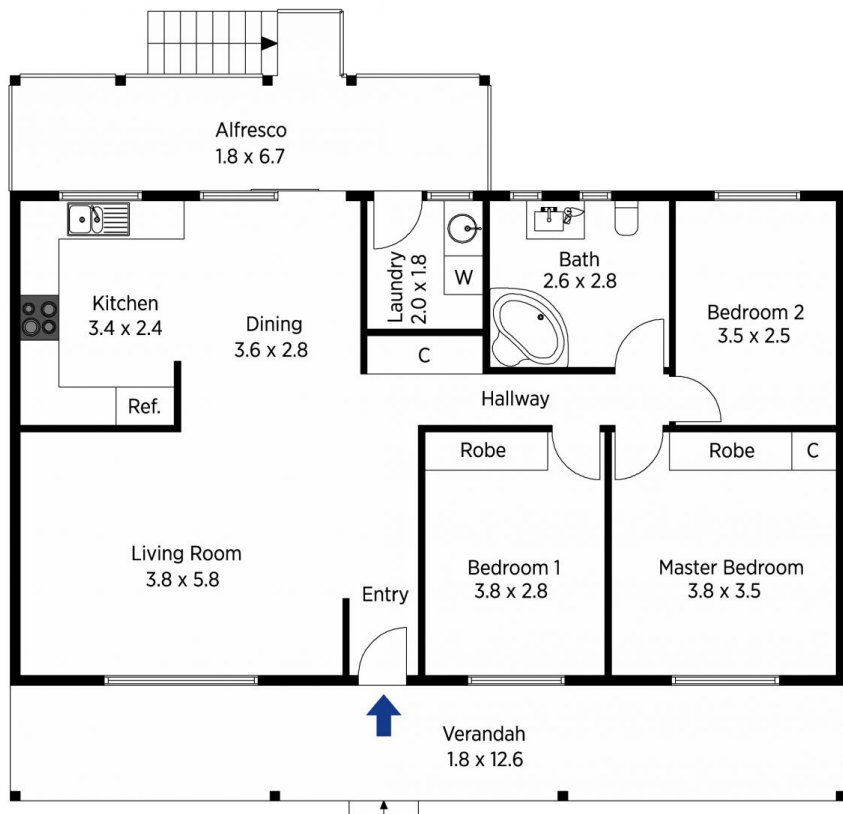

(Not In Position)

The floor plan is not to scale; measurements are indicative and in metres. Exterior elements are not in position. Plans should not be relied on. Interested parties should make and rely on their own enquiries.

Produced by DIAKRIT

78 Birdwood Avenue, Winmalee

Chapman