



### 44 Grose Road Faulconbridge NSW

3 1

**LOCATION** - Positioned on a large block of approx 1592m2, within 500m to both the primary and high school, convenient to local shops, sports & aquatic centre, Norman Lindsay Gallery and Buttenshaw Park.

**STYLE** - Single level brick home with tile roof, awaiting your renovation.

**LAYOUT** - Open living & dining area, 3 bedrooms, master with built in robes, original main bathroom, separate toilet and laundry.

**FEATURES** - No internal photos available, currently undergoing clearing. Home is functional but requires work internally. Backyard with rock features and valley views, off street parking for multiple vehicles.

Disclaimer: All information contained herein is gathered

[For full version visit the website](https://www.chapmanrealestate.com.au)

**Type** : House  
**Price** : \$ 505,000  
**Land Size** : 1592 sqm  
**View** : <https://www.chapmanrealestate.com.au/sale/nsw/hawkesbury/faulconbridge/residential/house/7161128>



**Helen Harris**  
02 4751 8266





The floor plan is not to scale; measurements are indicative and in metres. All features included in this 3D plan are for inspiration purposes only. This is not an exact replica of the property or the position of exterior elements. Plans should not be relied on. Interested parties should make and rely on their own enquiries.

Produced by DIAKRIT

44 Grose Road, Faulconbridge

Chapman

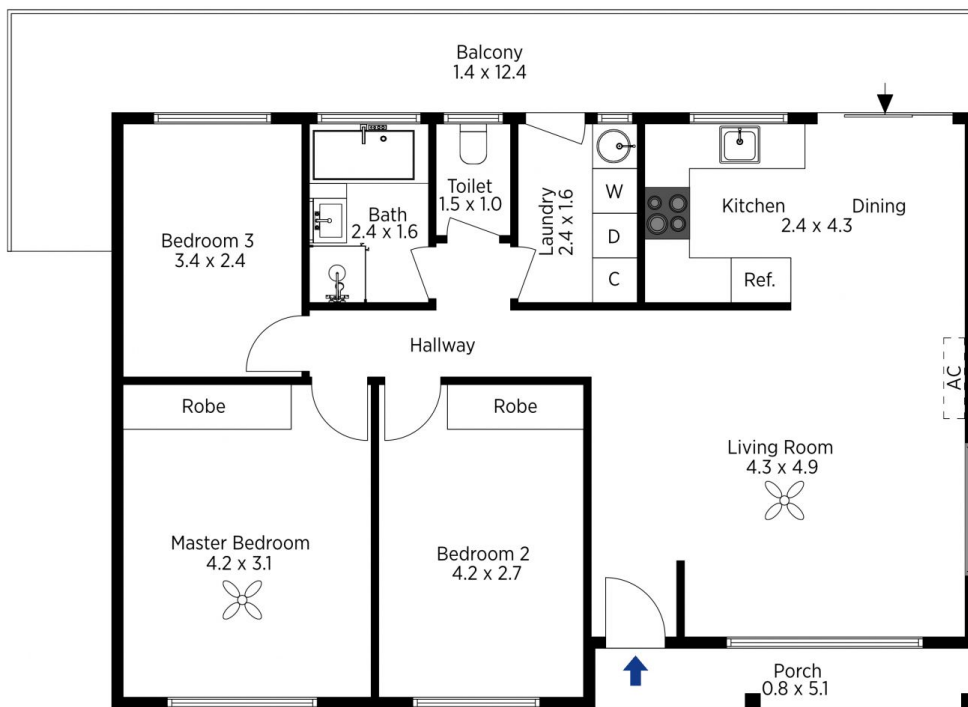

Off Street Parking  
10.4 x 2.6

(Not In Position)

The floor plan is not to scale; measurements are indicative and in metres. Exterior elements are not in position. Plans should not be relied on. Interested parties should make and rely on their own enquiries.

Produced by DIAKRIT

44 Grose Road, Faulconbridge

Chapman