



22 Perry Avenue Springwood NSW

3 2 2

LOCATION - Set high in a central position close to Springwood village, within 1km of sports & aquatic centre, convenient to Buttenshaw park, bushwalks, schools and easy access to the highway, 180m to bus.

STYLE - Two storey brick home with tile roof set on a large block of approximately 1176m² boasting a single owner since 1977.

LAYOUT - 2 living rooms, 3 double bedrooms, master with ensuite & built in robes, generous main bathroom with separate toilet, laundry, internal access to downstairs double lock-up garage.

FEATURES - Good size kitchen with feature tile splash back and stainless steel appliances, wood burner, established gardens, ample under house storage, fresh paint, newly exposed timber floor boards, garden views,

Type : House
Price : \$ 660,000
Land Size : 1176 sqm
View : <https://www.chapmanrealestate.com.au/sale/nsw/hawkesbury/springwood/residential/house/7161082>



Helen Harris
02 4751 8266



Mark Poole
02 4751 8266

[For full version visit the website](https://www.chapmanrealestate.com.au)

<https://www.chapmanrealestate.com.au>

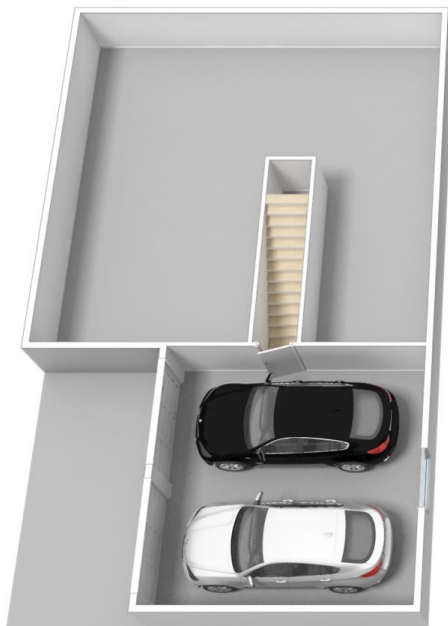

Basement Plan



Ground Floor

The floor plan is not to scale; measurements are indicative and in metres. All features included in this 3D plan are for inspiration purposes only. This is not an exact replica of the property or the position of exterior elements. Plans should not be relied on. Interested parties should make and rely on their own enquiries.

Produced by DIAKRIT

22 Perry Avenue, Springwood

Chapman

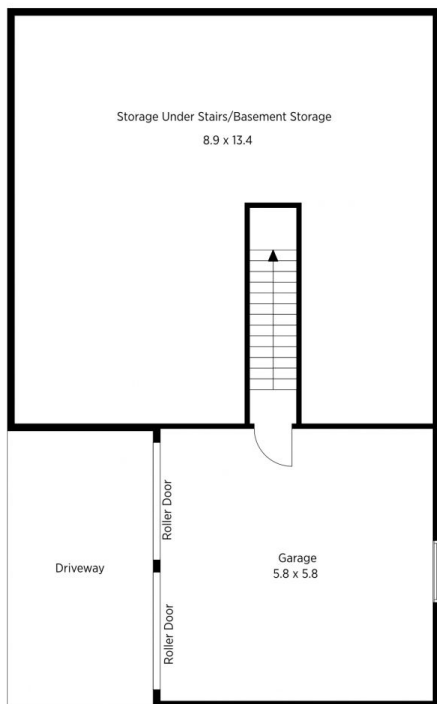

Basement Plan



Ground Floor

The floor plan is not to scale; measurements are indicative and in metres. Exterior elements are not in position. Plans should not be relied on. Interested parties should make and rely on their own enquiries.

Produced by DIAKRIT

22 Perry Avenue, Springwood

Chapman